

FORM NO. 1.

| | Courses along Allegany & Kiskiminitas | Distance |
|-----------|---|----------|
| 1 | N. 32 E. | 42 |
| 2 | N. 35 E. | 112 |
| 3 | N. 59 E. | 26 |
| 4 | S. 84 E. | 24 |
| 5 | S. 71 E. | 35 |
| 6 | S. 62 E. | 22 |
| 7 | S. 59 E. | 33 |
| 8 | S. 54 E. | 45 |
| 9 | S. 46 E. | 40 |
| 10 | S. 42 E. | 48 |
| Dist: 427 | | |

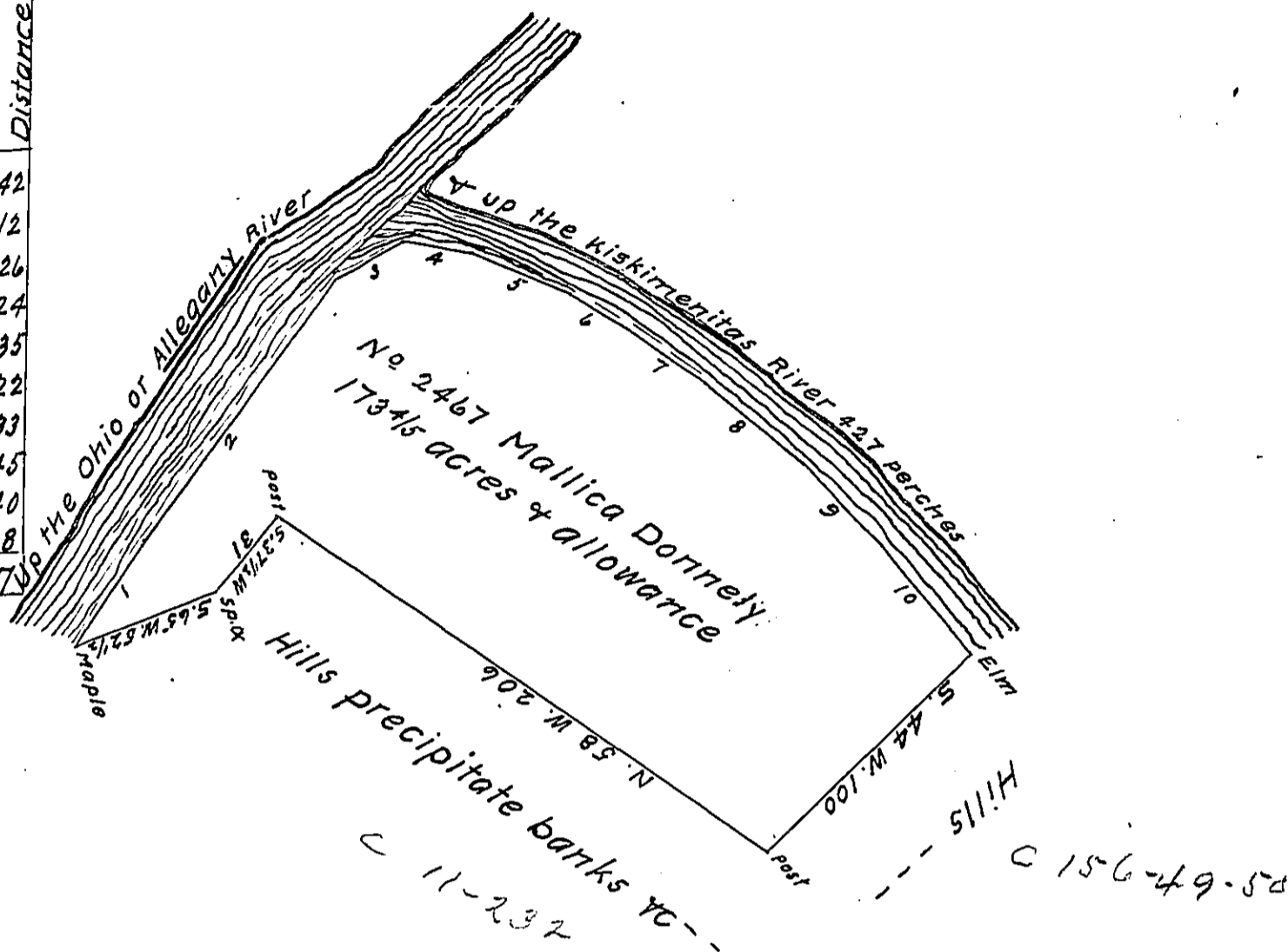

In pursuance of an order No 2467 dated the 3^d of April 1769 survey'd for Mallica Donnelly the above described tract of land containing one hundred and seventy three acres $\frac{4}{5}$ of an acre with an allowance proportioned to six pr. cent. situate on the South side of the Kiskiminitas, intersecting with Allegany River in Westmoreland County, survey'd the 30th of April 1770:

J. Robert McCrea
D. S.

To John Lukens Esq^r
S. Gen^l

IN TESTIMONY that the above is a copy of the original remaining on file in the Department of Internal Affairs of Pennsylvania, made conformably to an Act of Assembly approved the 16th day of February, 1833, I have hereunto set my Hand and caused the Seal of said Department to be affixed at Harrisburg, this fifth day of June 1912

Henry Houck
Secretary of Internal Affairs.